



Série
MPX

CABLAGE DES CONTACTS COAXIAUX TAILLE 8
CABLE ASNE 0691 WM

Edition :
02 SEPT 2002

Page
1 / 1

-POUR UTILISATION VERSION NON ETANCHE, GLISSER LE MANCHON DE RECENTRAGE SUR LE CABLE.
-POUR UTILISATION VERSION ETANCHE, GLISSER LE MANCHON D'ETANCHEITE SUR LE CABLE.

- 1/DENUDEUR LE CABLE COMME INDIQUE
COUPER LE RUBAN HAUTE IMMUNITE A 1MM DE LA TRESSE
COUPER L'AME ET LE DIELECTRIQUE A 8MM DE LA TRESSE

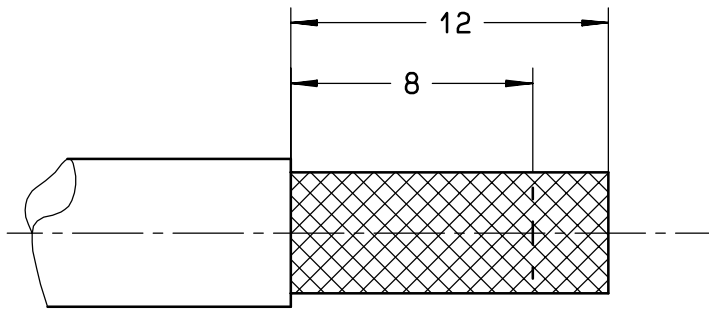

- 2/RAMENER LA TRESSE VERS L'AVANT, LA PEIGNER ET LA TORSADER A L'EXTREMITE
GLISSER LA FERRULE SUR LA TRESSE EN BUTEE CONTRE LA GAINÉ
RABATTRE LA TRESSE SUR LA FERRULE ET LA COUPER COMME INDIQUE
DENUDEUR L'AME DU CABLE COMME INDIQUE

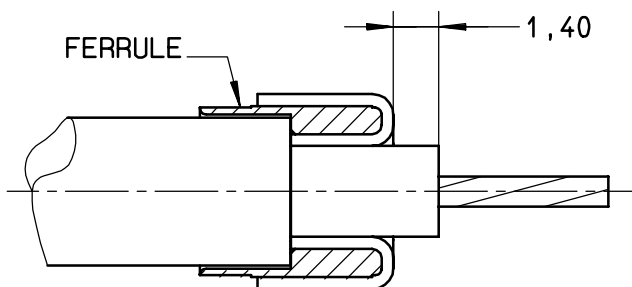

- 3/GLISSER L'AME DU CABLE DANS LE CONTACT CENTRAL, LE DIELECTRIQUE EN BUTEE CONTRE L'ISOLANT
SERTIR LE CONTACT CENTRAL

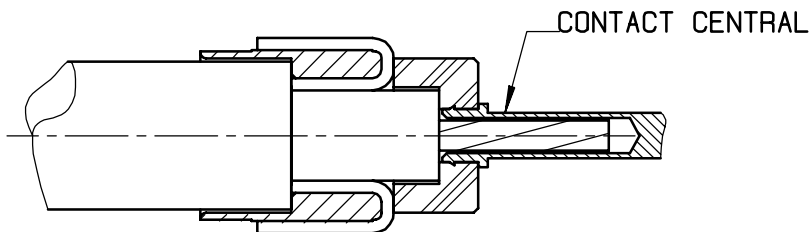

PINCE M 22520/2-01 RADIALL 282 281
SELECTEUR SUR 8
POSITIONNEUR RADIALL 282 572

- 4/INTRODUIRE L'ENSEMBLE EN BUTEE DANS LE CORPS EN POUSSANT SUR LA FERRULE
SERTIR LE FUT DU CONTACT EXTERIEUR DANS LA ZONE INDIQUEE
PENDANT LE SERTISSAGE, POUSSER SUR LE CABLE

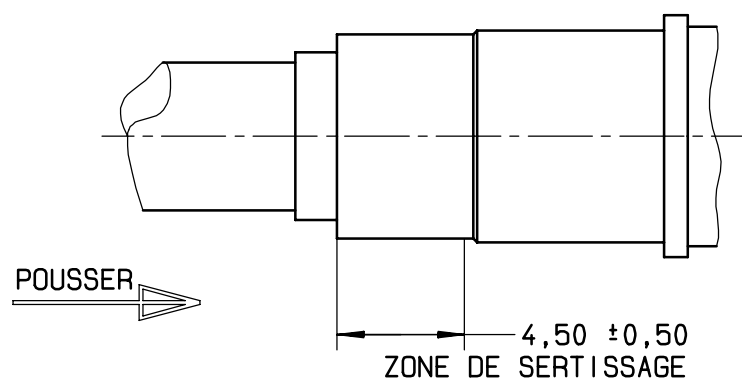

PINCE M 22520/5-01 RADIALL 282 293
MACHOIRES M22520/5-45 RADIALL 282 236
HEXAGONE A 5,9 SUR PLATS

- 5/OUTIL D'EXTRACTION M81969/28-03 RADIALL 282 549 001

4110-9610

CREATION				
PEN: .				
NOM: LF	25 SEP 02	PLAN REFAIT SUITE RAPPORT D'ESSAIS N°2002 07 0038	VALGRESY	DUPIUS
DATE: 17/10/90		MODIFIER PARAGRAPHE 1, 2 ET COTES DE DENUJAGE		
VERIF.: /	Edition	Modifications	Nom	Vérifié



Series
MPX

CABLING FOR SIZE 8 COAXIAL CONTACTS
ASNE 0691 WM CABLE
/

Issue:
18 AUGUST 00

Page
1 / 1

FOR NON ENVIRONMENTAL CONTACT, SLIDE THE CENTERING BOOT OVER CABLE
FOR ENVIRONMENTAL VERSION, SLIDE SEALING BOOT OVER CABLE

- 1/ STRIP CABLE AS SHOWN
CUT THE HIGH IMMUNITY RIBB ON .472
CUT INNER CONDUCTOR AND DIELECTRIC ON .315

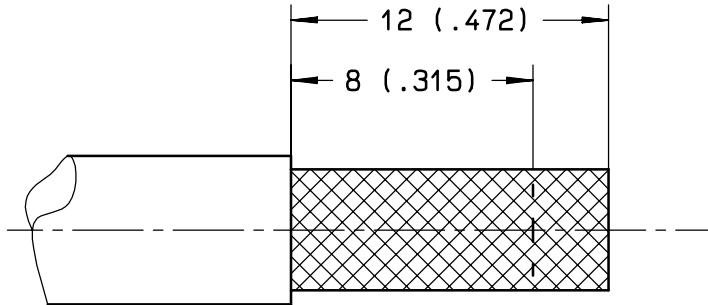

- 2/ COMB THE BRAID
SLIDE FERRULE OVER BRAID UNTIL IT BUTTS AGAINST THE CABLE JACKET
FOLD BACK BRAIDS OVER FERRULE AND CUT AS SHOWN
STRIP INNER CONDUCTOR AS SHOWN

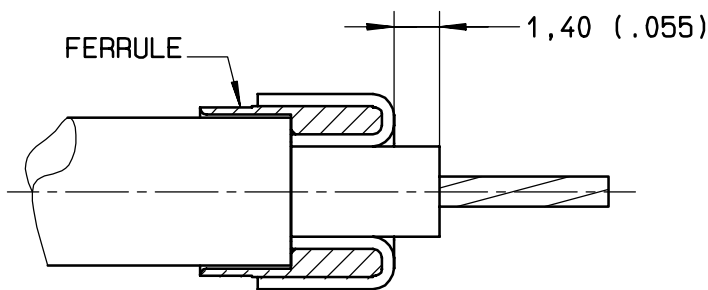

- 3/ SLIDE CENTER CONDUCTOR INTO CENTER CONTACT UNTIL DIELECTRIC BUTTS AGAINST CENTER CONTACT INSULATOR.
CRIMP CENTER CONTACT

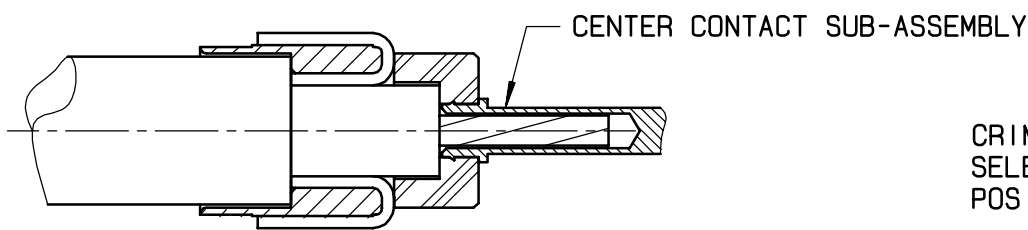

CRIMPING TOOL: M22520/2-01(RADIAL 282 281)
SELECTOR ON 8
POSITIONNER: RADIAL 282 572

- 4/ PUSH CABLE ASSEMBLY INTO OUTER BODY AND CRIMP
TAKE CARE TO CRIMP IN THE CRIMPING AREA
DURING CRIMPING, PUSH ON THE CABLE

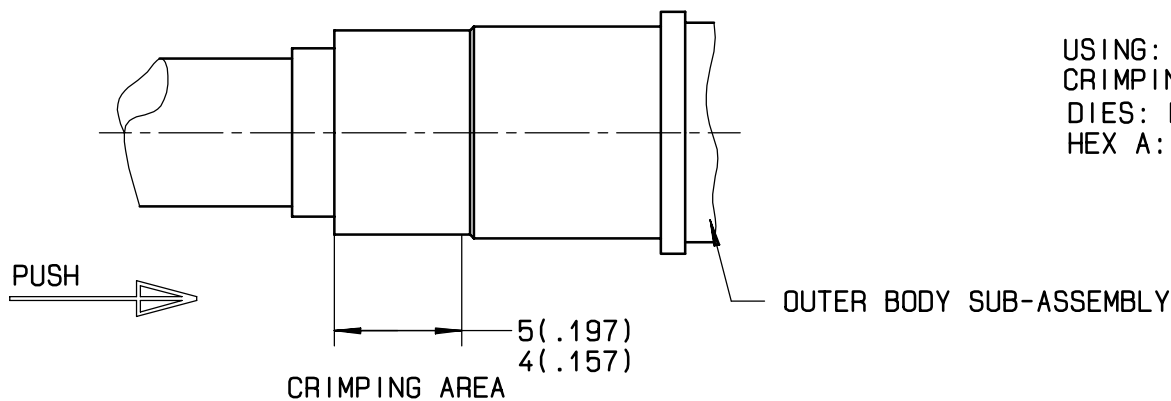

USING:
CRIMPING TOOL: M22520/5-01(RADIAL 282 293)
DIES: M22520/5-45(RADIAL 282 236)
HEX A: .232(5,9) ON FLATS

- 5/ EXTRACTION TOOL: M81969/28-03(RADIAL 282 549 001)

This information is given as an indication. In the continual goal to improve our products, we reserve the right to make any modifications judged necessary.

4112-9610

CREATION
PEN: /
NOM: LF
DATE: 17 OCT 90
APPR.: .	25 SEP 02	DRAWN IN US VERSION	VALGRESY	DUPUIS
	Issue	Revisions	Name	Approved